

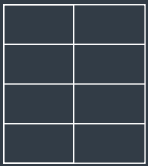
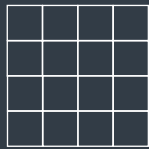

# Stratlock Range

## CEILINGS

This document describes the layout of clips for standard panels sizes in ceilings, listed below. For walls, please consult the Clip Layout Guide for wall panels.

For custom panels and/or custom application please contact the Fastmount team or Fastmount distributors for technical support.

	 4 x 4ft panels (1200 x 1200mm)	 4 x 2ft panels (1200 x 600mm)	 2 x 2ft panels (600 x 600mm)	 Complex geometries
Stratlock with rail system - suspended ceilings	Page 2	Page 6	Page 10	Page 14
Stratlock with rail system - screwed to T Bar	Page 3	Page 7	Page 11	Page 15
Stratlock with U channel or timber batten	Page 4	Page 8	Page 12	
SL-FC on plywood substrate	Page 5	Page 9	Page 13	Page 16

# Stratlock Range

## CEILING USING STRATLOCK RAIL SUSPENDED WITH THREADED ROD PANEL SIZE: 4 X 4FT / 1200 X 1200MM

This document describes the layout of clips for standard panels of the specified size. For custom panels and or custom application please contact Fastmount team or Fastmount distributors for technical support.

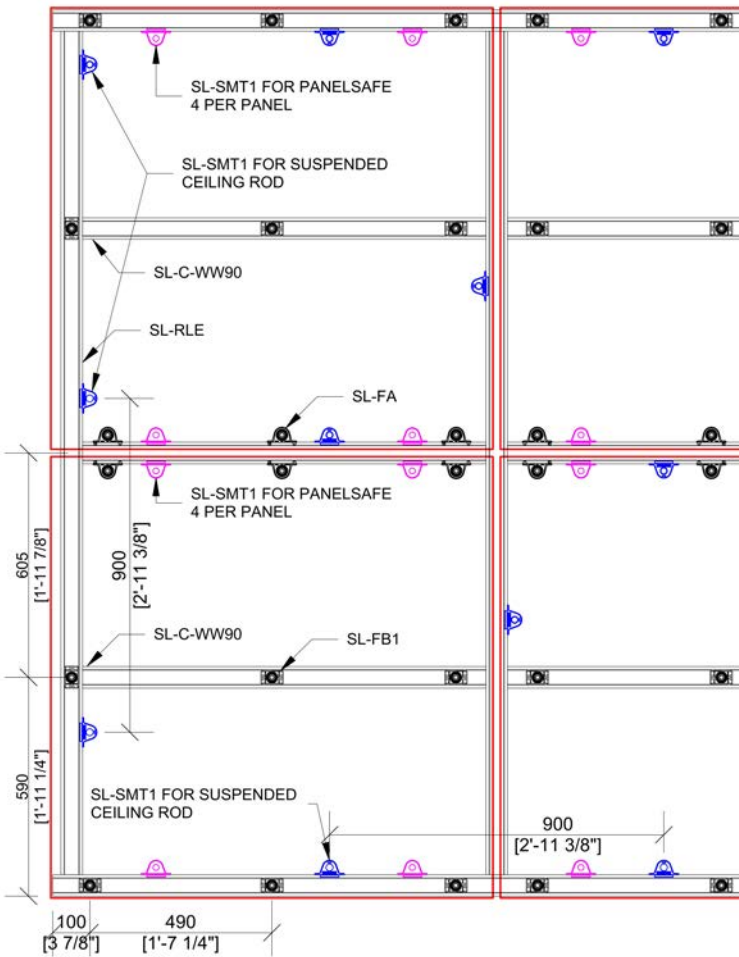

### VARIATIONS

- The maximum recommended distance between rails is 800mm / 2.6ft. Panels larger than described in this layout may require more horizontal rails.
- Place clips between 50 and 100mm / 2 and 4 inches from vertical edge of the panels.

### TIPS

- For light weight panels or very thin panels, more rails might be advised to avoid wavy edges.
- SL-SMT1 @ maximum 900mm/2'11" 3/8" centers and alternate each side as per center vertical rail

### PANEL WEIGHT LIMITS

- The maximum panel density for this application is 25kg per m<sup>2</sup> or 5lbs per square foot.
- Male clips SL-M10 can only be applied to panel densities of maximum 10kg per m<sup>2</sup> or 2lbs per square foot. Anything over this should be mounted with the SL-M18 male clips.

Model	Max panel weight density: Ceilings
SL-M10	10kg/m <sup>2</sup> (2lb/ft <sup>2</sup> )
SL-M18	25kg/m <sup>2</sup> (5lb/ft <sup>2</sup> )
SL-M18-FR	25kg/m <sup>2</sup> (5lb/ft <sup>2</sup> )

### QUANTITIES PER SPECIFIED PANEL SIZE

Imperial system

Product code	Description	Per 4 x 4ft area	Per square feet
SL-RLE	Aluminium extrusion	13ft	3.25ft/ft <sup>2</sup>
SL-FA	Female clip	3 units	2 units/ft <sup>2</sup>
SL-FB1	Female clip	6 units	2 units/ft <sup>2</sup>
SL-SMT1	Sidemount clip for PanelSafe and suspending frame	6 units	3 units/ft <sup>2</sup>
SL-C-WW90	Wall to wall connector	6 units	4 units/ft <sup>2</sup>
SL-M10 or M18	Male clip	9 units	4 units/ft <sup>2</sup>

Metric system

Product code	Description	Per 1.2 x 1.2m area	Per square meter
SL-RLE	Aluminium extrusion	4m	3m/m <sup>2</sup>
SL-FA	Female clip	3 units	2 units/m <sup>2</sup>
SL-FB1	Female clip	6 units	4 units/m <sup>2</sup>
SL-SMT1	Sidemount clip for PanelSafe and suspending frame	6 units	3 units/m <sup>2</sup>
SL-C-WW90	Wall to wall connector	6 units	4 units/m <sup>2</sup>
SL-M10 or M18	Male clip	9 units	6 units/m <sup>2</sup>

# Stratlock Range

## CEILING USING STRATLOCK RAIL SCREWED TO TBAR PANEL SIZE: 4 X 4FT / 1200 X 1200MM

This document describes the layout of clips for standard panels of the specified size. For custom panels and or custom application please contact Fastmount team or Fastmount distributors for technical support.

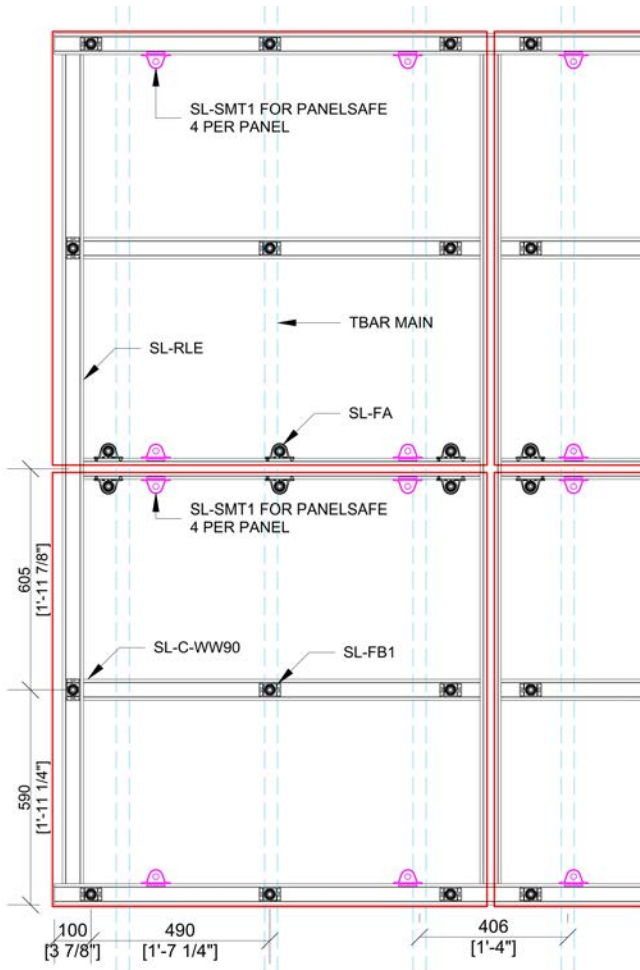

### VARIATIONS

- The maximum recommended distance between rails is 800mm / 2.6ft. Panels larger than described in this layout might require more horizontal rails.
- Place clips between 50 and 100mm / 2 and 4 inches from vertical edge of the panels.

### TIPS

- For light weight panels or very thin panels, more rails might be advised to avoid wavy edges.

### PANEL WEIGHT LIMITS

- The maximum panel density for this application is 25kg per m<sup>2</sup> or 5lbs per square foot.
- Male clips SL-M10 can only be applied to panel densities of maximum 10kg per m<sup>2</sup> or 2lbs per square foot. Anything over this should be mounted with the SL-M18 male clips.

Model	Max panel weight density: Ceilings
SL-M10	10kg/m <sup>2</sup> (2lb/ft <sup>2</sup> )
SL-M18	25kg/m <sup>2</sup> (5lb/ft <sup>2</sup> )
SL-M18-FR	25kg/m <sup>2</sup> (5lb/ft <sup>2</sup> )

### QUANTITIES PER SPECIFIED PANEL SIZE

Imperial system

Product code	Description	Per 4 x 4ft area	Per square feet
SL-RLE	Aluminium extrusion	13ft	3.25ft/ft <sup>2</sup>
SL-FA	Female clip	3 units	2 units/ft <sup>2</sup>
SL-FB1	Female clip	6 units	3 units/ft <sup>2</sup>
SL-SMT1	Sidemount clip for PanelSafe	4 units	1 units/ft <sup>2</sup>
SL-C-WW90	Wall to wall connector	6 units	4 units/ft <sup>2</sup>
SL-M10 or M18	Male clip	9 units	4 units/ft <sup>2</sup>

Metric system

Product code	Description	Per 1.2 x 1.2m area	Per square meter
SL-RLE	Aluminium extrusion	4m	3m/m <sup>2</sup>
SL-FA	Female clip	3 units	2 units/m <sup>2</sup>
SL-FB1	Female clip	6 units	4 units/m <sup>2</sup>
SL-SMT1	Sidemount clip for PanelSafe	4 units	4 units/m <sup>2</sup>
SL-C-WW90	Wall to wall connector	6 units	4 units/m <sup>2</sup>
SL-M10 or M18	Male clip	9 units	6 units/m <sup>2</sup>

# Stratlock Range

## CEILING USING ALUMINIUM U CHANNEL 1" X 1" X 1/8" / 25 X 25 X 3MM PANEL SIZE: 4 X 4FT / 1200 X 1200MM

This document describes the layout of clips for standard panels of that size. For custom panels and or custom application please contact Fastmount team or Fastmount distributors for technical support.

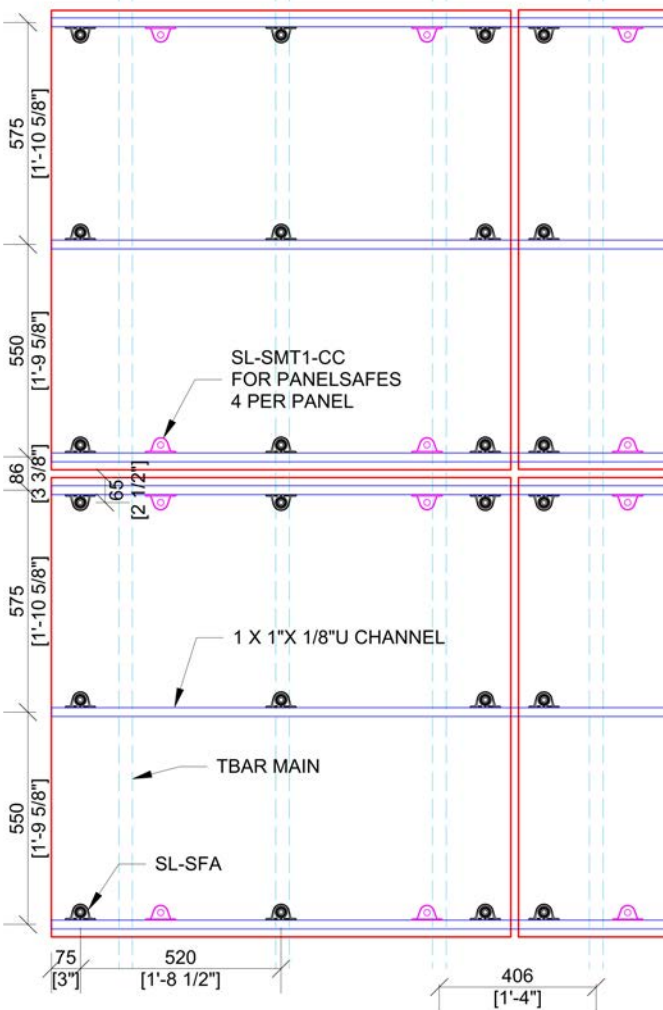

### VARIATIONS

- The maximum recommended distance between rails is 800mm / 2.6ft. Panels larger than described in this layout may require more U channels.
- Place clips between 50 and 100mm / 2 and 4 inches from vertical edge of the panels.

### TIPS

- For light weight panels or very thin panels, more U channels might be advised to avoid wavy edges.
- Box section or RHS section can also be used in place of the U channel.
- Timber battens can also be used in place of the U channel.

### PANEL WEIGHT LIMITS

- The maximum panel density for this application is 25kg per m<sup>2</sup> or 5lbs per square foot.
- Male clips SL-M10 can only be applied to panel densities of maximum 15kg per m<sup>2</sup> or 3lbs per square foot. Anything over this should be mounted with the SL-M18 male clips.

Model	Max panel weight density: Ceilings
SL-M10	10kg/m <sup>2</sup> (2lb/ft <sup>2</sup> )
SL-M18	25kg/m <sup>2</sup> (5lb/ft <sup>2</sup> )
SL-M18-FR	25kg/m <sup>2</sup> (5lb/ft <sup>2</sup> )

### QUANTITIES PER SPECIFIED PANEL SIZE

Imperial system

Product code	Description	Per 4 x 4ft area	Per square feet
Orange 1"x 1"x 1/8"	Aluminium U channel	12ft	1ft/ft <sup>2</sup>
SL-SFA1	Female clip	9 units	2 units/ft <sup>2</sup>
SL-SMT1-CC	Sidemount clip for PanelSafe	4 units	1 units/ft <sup>2</sup>
SL-M10 or M18	Male clip	9 units	2 units/ft <sup>2</sup>

Metric system

Product code	Description	Per 1.2 x 1.2m area	Per square meter
Orange 1"x 1"x 1/8"	Aluminium U channel	3.6m	2.0m/m <sup>2</sup>
SL-SFA1	Female clip	9 units	4 units/m <sup>2</sup>
SL-SMT1-CC	Sidemount clip for PanelSafe	4 units	2 units/m <sup>2</sup>
SL-M10 or M18	Male clip	9 units	4 units/m <sup>2</sup>



# Stratlock Range

## CEILING USING STRATLOCK SL-FC SET INTO PLYWOOD PANEL SIZE: 4 X 4FT / 1200 X 1200MM

This document describes the layout of clips for standard panels of the specified size. For custom panels and or custom application please contact Fastmount team or Fastmount distributors for technical support.

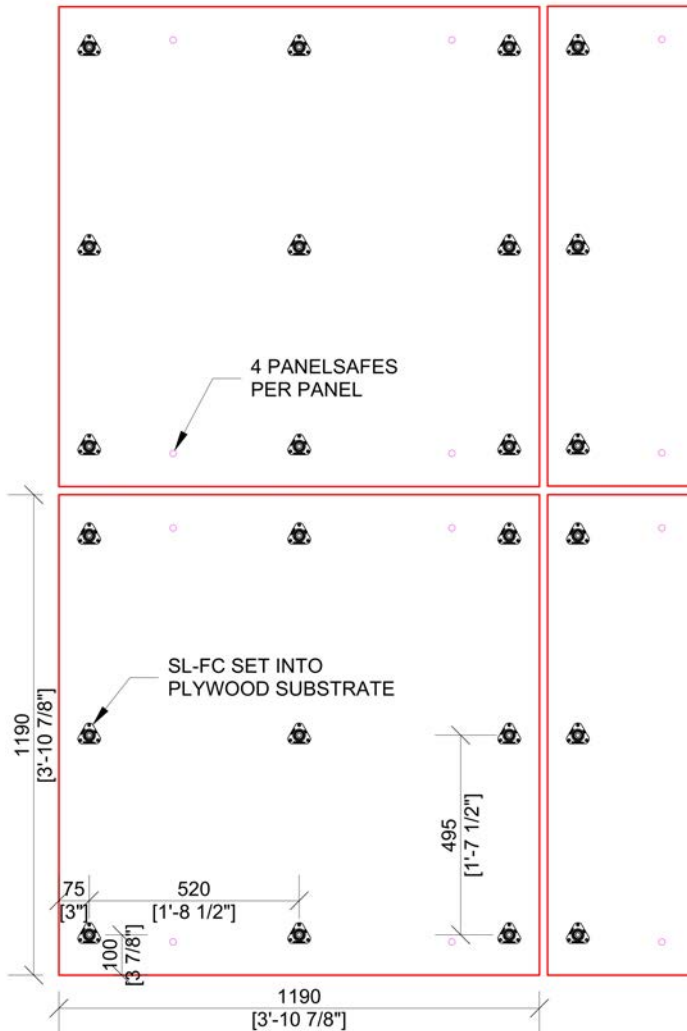

### VARIATIONS

- The maximum recommended center to center distance between SL-FC is 600mm / 24".
- Place clips between 50 and 100mm / 2 and 4 inches from vertical edge of the panels.

### TIPS

- For light weight panels or very thin panels, more clips might be advised to avoid wavy edges.

### PANEL WEIGHT LIMITS

- The maximum panel density for this application is 25kg per m<sup>2</sup> or 5lbs per square foot.
- Male clips SL-M10 can only be applied to panel densities of maximum 10kg per m<sup>2</sup> or 2lbs per square foot. Anything over this should be mounted with the SL-M18 male clips.

Model	Max panel weight density: Ceilings
SL-M10	10kg/m <sup>2</sup> (2lb/ft <sup>2</sup> )
SL-M18	25kg/m <sup>2</sup> (5lb/ft <sup>2</sup> )
SL-M18-FR	25kg/m <sup>2</sup> (5lb/ft <sup>2</sup> )

### QUANTITIES PER SPECIFIED PANEL SIZE

Imperial system

Product code	Description	Per 4 x 4ft area	Per square feet
SL-FC	Female clip	9 units	1 units/ft <sup>2</sup>
PanelSafe	PanelSafe restraint	4 units	1 units/ft <sup>2</sup>
SL-M10 or M18	Male clip	9 units	1 units/ft <sup>2</sup>

Metric system

Product code	Description	Per 1.2 x 1.2m area	Per square meter
SL-FC	Female clip	9 units	4 units/m <sup>2</sup>
PanelSafe	PanelSafe restraint	4 units	4 units/m <sup>2</sup>
SL-M10 or M18	Male clip	9 units	4 units/m <sup>2</sup>



# Stratlock Range

## CEILING USING STRATLOCK RAIL SUSPENDED PANEL SIZE: 4 X 2FT / 1200 X 600MM

This document describes the layout of clips for standard panels of the specified size. For custom panels and or custom application please contact Fastmount team or Fastmount distributors for technical support.

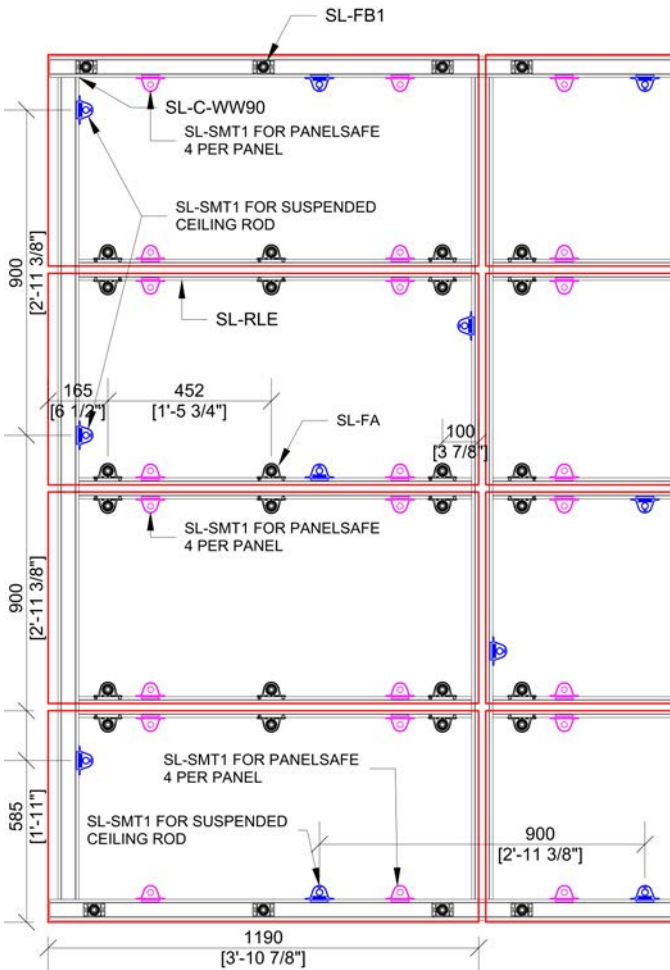

### VARIATIONS

- The maximum recommended distance between rails is 800mm / 2.6ft. Panels bigger than described in this layout might require more than 2 horizontal rails.
- Place clips between 50 and 100mm / 2 and 4 inches from vertical edge of the panels.

### TIPS

- For light weight panels or very thin panels, more rails might be advised to avoid wavy edges.
- SL-SMT1 @ maximum 900mm/2'11" 3/8" centers and alternate each side as per center vertical rail

### PANEL WEIGHT LIMITS

- The maximum panel density for this application is 25kg per m<sup>2</sup> or 5lbs per square foot
- Male clips SL-M10 can only be applied to panel densities of maximum 15kg per m<sup>2</sup> or 3lbs per square foot. Anything over this should be mounted with the SL-M18 male clips.

Model	Max panel weight density: Ceilings
SL-M10	10kg/m <sup>2</sup> (2lb/ft <sup>2</sup> )
SL-M18	25kg/m <sup>2</sup> (5lb/ft <sup>2</sup> )
SL-M18-FR	25kg/m <sup>2</sup> (5lb/ft <sup>2</sup> )

### QUANTITIES PER SPECIFIED PANEL SIZE

Imperial system

Product code	Description	Per 4 x 2ft area	Per square feet
SL-RLE	Aluminium extrusion	11.8ft	1.40ft/ft <sup>2</sup>
SL-FA1	Female clip	3 units	0.56 units/ft <sup>2</sup>
SL-FB1	Female clip	3 units	1 units/ft <sup>2</sup>
SL-SMT1	Sidemount clip for PanelSafe and suspending frame	6 units	4 units/ft <sup>2</sup>
SL-C-WW90	Wall to wall connector	4 units	4 units/ft <sup>2</sup>
SL-M10 or M18	Male clip	6 units	1 units/ft <sup>2</sup>

Metric system

Product code	Description	Per 1.2 x 0.6m area	Per square meter
SL-RLE	Aluminium extrusion	3.6m	2.6m/m <sup>2</sup>
SL-FA1	Female clip	3 units	6.25 units/m <sup>2</sup>
SL-FB1	Female clip	3 units	2 units/m <sup>2</sup>
SL-SMT1	Sidemount clip for PanelSafe and suspending frame	6 units	4 units/m <sup>2</sup>
SL-C-WW90	Wall to wall connector	4 units	4 units/m <sup>2</sup>
SL-M10 or M18	Male clip	6 units	4 units/m <sup>2</sup>



# Stratlock Range

## CEILING USING STRATLOCK RAIL SCREWED TO TBAR PANEL SIZE: 4 X 2FT / 1200 X 600MM

This document describes the layout of clips for standard panels of the specified size. For custom panels and or custom application please contact Fastmount team or Fastmount distributors for technical support.

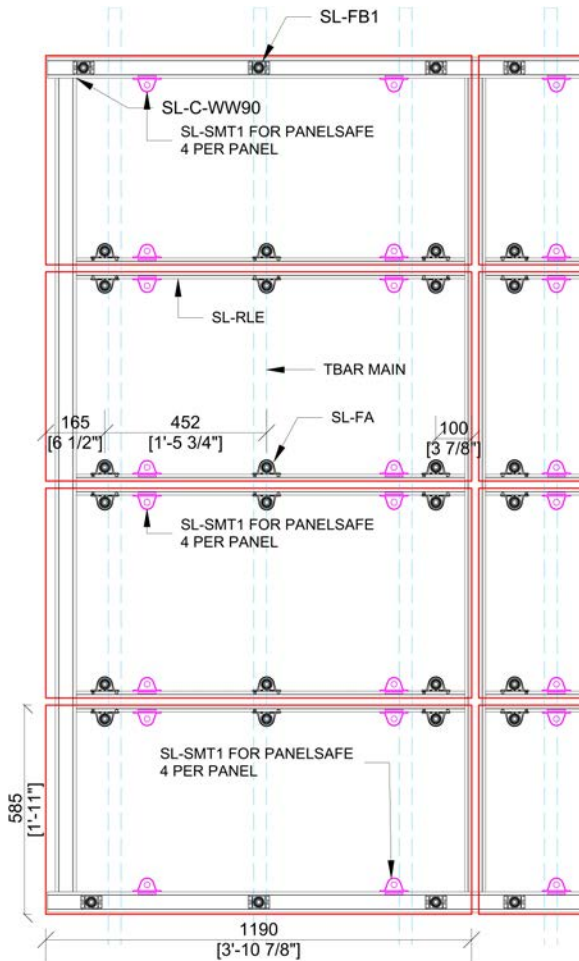

### VARIATIONS

- The maximum recommended distance between rails is 800mm / 2.6ft. Panels larger than described in this layout might require more than 2 horizontal rails.
- Place clips between 50 and 100mm / 2 and 4 inches from vertical edge of the panels.

### TIPS

- For light weight panels or very thin panels, more rails might be advised to avoid wavy edges.

### PANEL WEIGHT LIMITS

- The maximum panel density for this application is 25kg per m<sup>2</sup> or 5lbs per square foot.
- Male clips SL-M10 can only be applied to panel densities of maximum 15kg per m<sup>2</sup> or 3lbs per square foot. Anything over this should be mounted with the SL-M18 male clips.

Model	Max panel weight density: Ceilings
SL-M10	10kg/m <sup>2</sup> (2lb/ft <sup>2</sup> )
SL-M18	25kg/m <sup>2</sup> (5lb/ft <sup>2</sup> )
SL-M18-FR	25kg/m <sup>2</sup> (5lb/ft <sup>2</sup> )

### QUANTITIES PER SPECIFIED PANEL SIZE

Imperial system

Product code	Description	Per 4 x 2ft area	Per square feet
SL-RLE	Aluminium extrusion	11.8ft	1.40ft/ft <sup>2</sup>
SL-FA1	Female clip	3 units	0.56 units/ft <sup>2</sup>
SL-FB1	Female clip	3 units	1 units/ft <sup>2</sup>
SL-SMT1	Sidemount clip for PanelSafe	4 units	4 units/ft <sup>2</sup>
SL-C-WW90	Wall to wall connector	4 units	4 units/ft <sup>2</sup>
SL-M10 or M18	Male clip	6 units	1 units/ft <sup>2</sup>

Metric system

Product code	Description	Per 1.2 x 0.6m area	Per square meter
SL-RLE	Aluminium extrusion	3.6m	2.6m/m <sup>2</sup>
SL-FA1	Female clip	3 units	6.25 units/m <sup>2</sup>
SL-FB1	Female clip	3 units	2 units/m <sup>2</sup>
SL-SMT1	Sidemount clip for PanelSafe	4 units	4 units/m <sup>2</sup>
SL-C-WW90	Wall to wall connector	4 units	4 units/m <sup>2</sup>
SL-M10 or M18	Male clip	6 units	4 units/m <sup>2</sup>

# Stratlock Range

CEILING USING ALUMINIUM U CHANNEL 1" X 1" X 1/8" / 25 X 25 X 3MM  
 PANEL SIZE: 4 X 2FT / 1200 X 600MM

This document describes the layout of clips for standard panels of that size. For custom panels and or custom application please contact Fastmount team or Fastmount distributors for technical support.

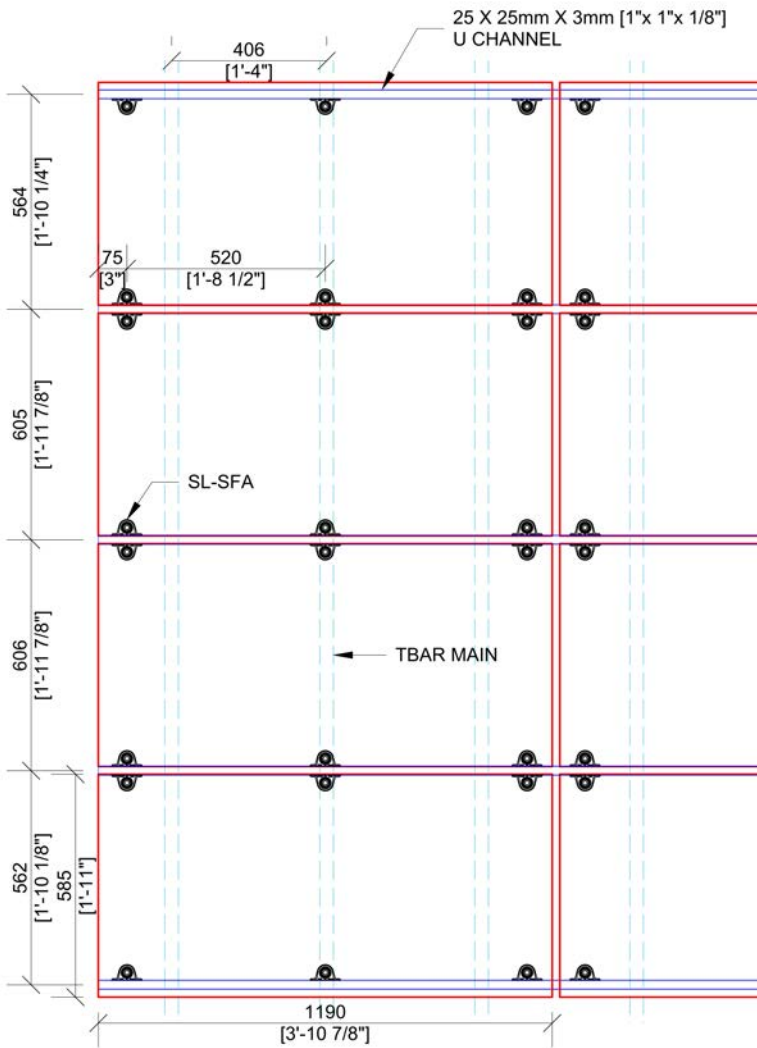

## VARIATIONS

- The maximum recommended distance between rails is 800mm / 2.6ft. Panels larger than described in this layout might require more horizontal extrusions.
- Place clips between 50 and 100mm / 2 and 4 inches from vertical edge of the panels.

## TIPS

- For light weight panels or very thin panels, more U channels might be advised to avoid wavy edges.
- Box section or RHS section can also be used in place of the U channel.
- Timber battens can also be used in place of the U channel.

## PANEL WEIGHT LIMITS

- The maximum panel density for this application is 25kg per m<sup>2</sup> or 5lbs per square foot.
- Male clips SL-M10 can only be applied to panel densities of maximum 15kg per m<sup>2</sup> or 3lbs per square foot. Anything over this should be mounted with the SL-M18 male clips.

Model	Max panel weight density: Ceilings
SL-M10	15kg/m <sup>2</sup> (3lb/ft <sup>2</sup> )
SL-M18	25kg/m <sup>2</sup> (5lb/ft <sup>2</sup> )
SL-M18-FR	25kg/m <sup>2</sup> (5lb/ft <sup>2</sup> )

## QUANTITIES PER SPECIFIED PANEL SIZE

Imperial system

Product code	Description	Per 4 x 2ft area	Per square feet
Orange 1"x 1"x 1/8"	Aluminium U channel	8ft	1ft/ft <sup>2</sup>
SL-SFA1	Female clip	6 units	1 units/ft <sup>2</sup>
SL-M10 or M18	Male clip	6 units	1 units/ft <sup>2</sup>

Metric system

Product code	Description	Per 1.2 x 0.6m area	Per square meter
Orange 1"x 1"x 1/8"	Aluminium U channel	2.4m	2m/m <sup>2</sup>
SL-SFA1	Female clip	6 units	6 units/m <sup>2</sup>
SL-M10 or M18	Male clip	6 units	6 units/m <sup>2</sup>



# Stratlock Range

## CEILING USING STRATLOCK SL-FC SET INTO PLYWOOD

PANEL SIZE: 4 X 2FT / 1200 X 600MM

This document describes the layout of clips for standard panels of the specified size. For custom panels and or custom application please contact Fastmount team or Fastmount distributors for technical support.

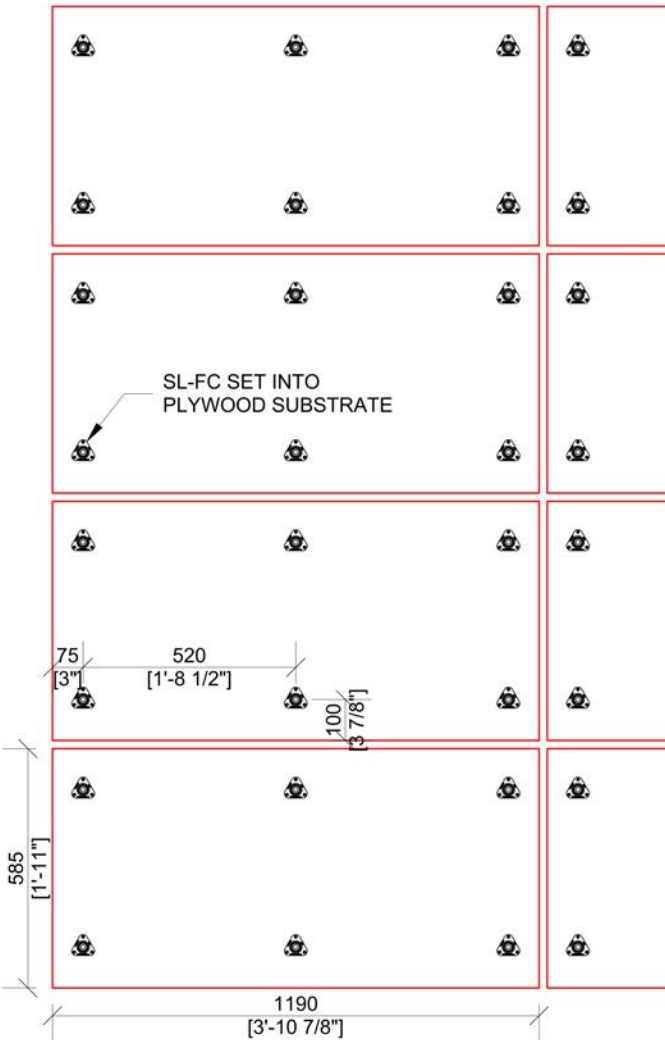

### VARIATIONS

- The maximum recommended center to center distance between SL-FC is 600mm / 24".
- Place clips between 50 and 100mm / 2 and 4 inches from vertical edge of the panels.

### TIPS

- For light weight panels or very thin panels, more clips might be advised to avoid wavy edges.

### PANEL WEIGHT LIMITS

- The maximum panel density for this application is 25kg per m<sup>2</sup> or 5lbs per square foot.
- Male clips SL-M10 can only be applied to panel densities of maximum 10kg per m<sup>2</sup> or 2lbs per square foot. Anything over this should be mounted with the SL-M18 male clips.

Model	Max panel weight density: Ceilings
SL-M10	10kg/m <sup>2</sup> (2lb/ft <sup>2</sup> )
SL-M18	25kg/m <sup>2</sup> (5lb/ft <sup>2</sup> )
SL-M18-FR	25kg/m <sup>2</sup> (5lb/ft <sup>2</sup> )

### QUANTITIES PER SPECIFIED PANEL SIZE

Imperial system

Product code	Description	Per 4 x 2ft area	Per square feet
SL-FC	Female clip	6 units	1 units/ft <sup>2</sup>
SL-M10 or M18	Male clip	6 units	1 units/ft <sup>2</sup>

Metric system

Product code	Description	Per 1.2 x 0.6m area	Per square meter
SL-FC	Female clip	6 units	9 units/m <sup>2</sup>
SL-M10 or M18	Male clip	6 units	9 units/m <sup>2</sup>



# Stratlock Range

## CEILING USING STRATLOCK RAIL SUSPENDED WITH THREADED ROD PANEL SIZE: 2 X 2FT / 600 X 600MM

This document describes the layout of clips for standard panels of the specified size. For custom panels and or custom application please contact Fastmount team or Fastmount distributors for technical support.

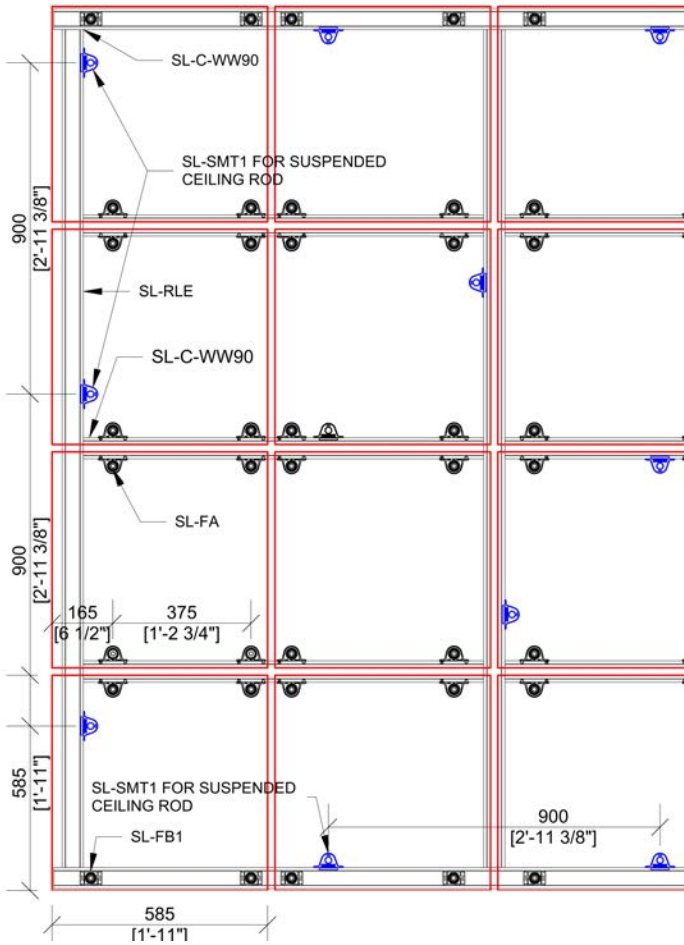

### VARIATIONS

- The maximum recommended distance between rails is 800mm / 2.6ft. Panels in between will require the rail spacings to adjust to a maximum of 800mm but still fitting to the panel.
- Place clips between 50 and 100mm / 2 and 4 inches from vertical edge of the panels.

### TIPS

- For light weight panels or very thin panels, more rails might be advised to avoid wavy edges.
- SL-SMT1 @ maximum 900mm/2'11" 3/8" centers and alternate each side as per center vertical rail

### PANEL WEIGHT LIMITS

- The maximum panel density for this application is 25kg per m<sup>2</sup> or 5lbs per square foot.
- Male clips SL-M10 can only be applied to panel densities of maximum 10kg per m<sup>2</sup> or 2lbs per square foot. Anything over this should be mounted with the SL-M18 male clips.

Model	Max panel weight density: Ceilings
SL-M10	10kg/m <sup>2</sup> (2lb/ft <sup>2</sup> )
SL-M18	25kg/m <sup>2</sup> (5lb/ft <sup>2</sup> )
SL-M18-FR	25kg/m <sup>2</sup> (5lb/ft <sup>2</sup> )

### QUANTITIES PER SPECIFIED PANEL SIZE

Imperial system

Product code	Description	Per 2 x 2ft area	Per square feet
SL-RLE	Aluminium extrusion	5.9ft	2ft/ft <sup>2</sup>
SL-FA	Female clip	2 units	1 units/ft <sup>2</sup>
SL-FB1	Female clip	2 units	1 units/ft <sup>2</sup>
SL-SMT1	Sidemount clip	1 units	1 units/ft <sup>2</sup>
SL-C-WW90	Wall to wall connector	2 units	2 units/ft <sup>2</sup>
SL-M10 or M18	Male clip	4 units	1 units/ft <sup>2</sup>

Metric system

Product code	Description	Per 0.6 x 0.6m area	Per square meter
SL-RLE	Aluminium extrusion	1.8m	2.87m/m <sup>2</sup>
SL-FA	Female clip	2 units	6 units/m <sup>2</sup>
SL-FB1	Female clip	2 units	3 units/m <sup>2</sup>
SL-SMT1	Sidemount clip	1 units	2 units/m <sup>2</sup>
SL-C-WW90	Wall to wall connector	2 units	2 units/m <sup>2</sup>
SL-M10 or M18	Male clip	4 units	9 units/m <sup>2</sup>



# Stratlock Range

## CEILING USING STRATLOCK RAIL SCREWED TO TBAR PANEL SIZE: 2 X 2FT / 600 X 600MM

This document describes the layout of clips for standard panels of the specified size. For custom panels and or custom application please contact Fastmount team or Fastmount distributors for technical support.

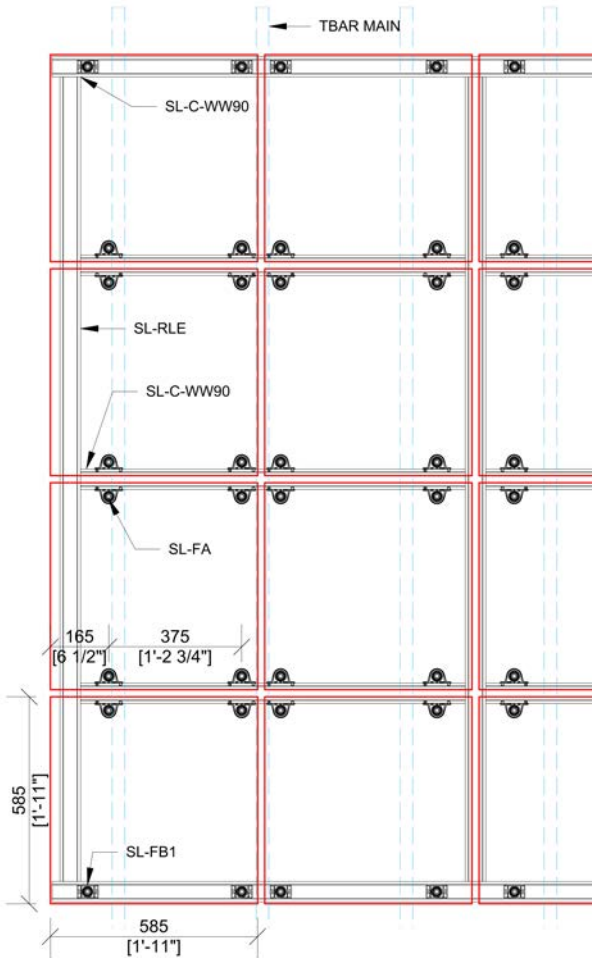

### VARIATIONS

- The maximum recommended distance between rails is 800mm / 2.6ft. Panels in between will require the rail spacings to adjust to a maximum of 800mm but still fitting to the panel.
- Place clips between 50 and 100mm / 2 and 4 inches from vertical edge of the panels.

### TIPS

- For light weight panels or very thin panels, more rails might be advised to avoid wavy edges.

### PANEL WEIGHT LIMITS

- The maximum panel density for this application is 25kg per m<sup>2</sup> or 5lbs per square foot.
- Male clips SL-M10 can only be applied to panel densities of maximum 10kg per m<sup>2</sup> or 2lbs per square foot. Anything over this should be mounted with the SL-M18 male clips.

Model	Max panel weight density: Ceilings
SL-M10	10kg/m <sup>2</sup> (2lb/ft <sup>2</sup> )
SL-M18	25kg/m <sup>2</sup> (5lb/ft <sup>2</sup> )
SL-M18-FR	25kg/m <sup>2</sup> (5lb/ft <sup>2</sup> )

### QUANTITIES PER SPECIFIED PANEL SIZE

Imperial system

Product code	Description	Per 2 x 2ft area	Per square feet
SL-RLE	Aluminium extrusion	5.9ft	2ft/ft <sup>2</sup>
SL-FA	Female clip	2 units	1 units/ft <sup>2</sup>
SL-FB1	Female clip	2 units	1 units/ft <sup>2</sup>
SL-C-WW90	Wall to wall connector	2 units	2 units/ft <sup>2</sup>
SL-M10 or M18	Male clip	4 units	1 units/ft <sup>2</sup>

Metric system

Product code	Description	Per 0.6 x 0.6m area	Per square meter
SL-RLE	Aluminium extrusion	1.8m	2.87m/m <sup>2</sup>
SL-FA	Female clip	2 units	6 units/m <sup>2</sup>
SL-FB1	Female clip	2 units	3 units/m <sup>2</sup>
SL-C-WW90	Wall to wall connector	2 units	2 units/m <sup>2</sup>
SL-M10 or M18	Male clip	4 units	9 units/m <sup>2</sup>



# Stratlock Range

## CEILING USING ALUMINIUM U CHANNEL 1" X 1" X 1/8" / 25 X 25 X 3MM PANEL SIZE: 2 X 2FT / 600 X 600MM

This document describes the layout of clips for standard panels of that size. For custom panels and or custom application please contact Fastmount team or Fastmount distributors for technical support.

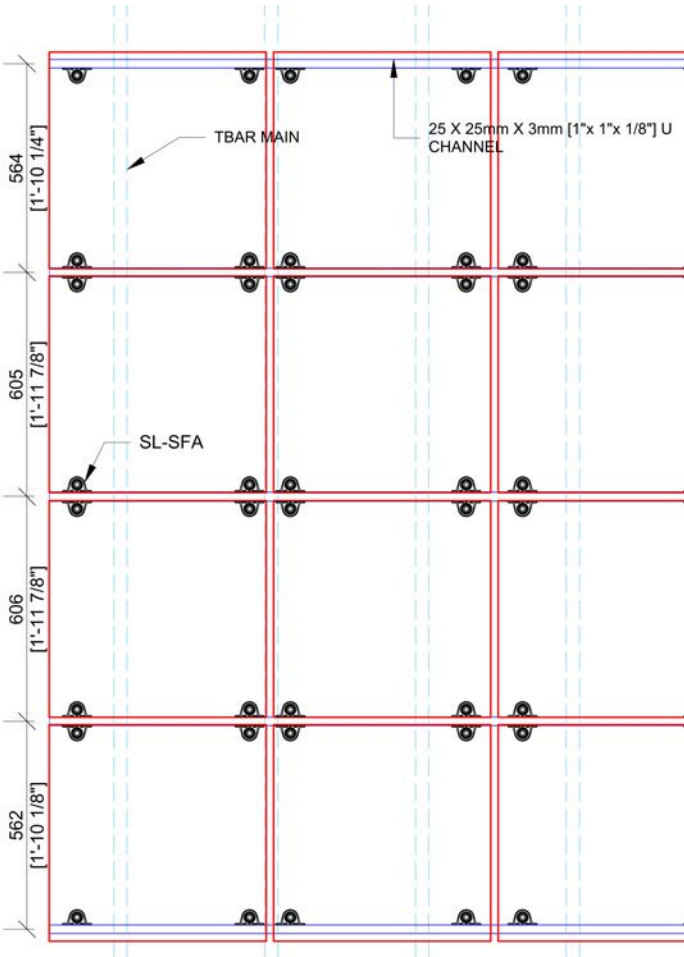

### VARIATIONS

- The maximum recommended distance between rails is 800mm / 2.6ft. Panels larger than described in this layout might require more horizontal rails.
- Place clips between 50 and 100mm / 2 and 4 inches from vertical edge of the panels.

### TIPS

- For light weight panels or very thin panels, more U channels might be advised to avoid wavy edges.
- Box section or RHS section can also be used in place of the U channel.
- Timber battens can also be used in place of the U channel.

### PANEL WEIGHT LIMITS

- The maximum panel density for this application is 25kg per m<sup>2</sup> or 5lbs per square foot.
- Male clips SL-M10 can only be applied to panel densities of maximum 15kg per m<sup>2</sup> or 3lbs per square foot. Anything over this should be mounted with the SL-M18 male clips.

Model	Max panel weight density: Ceilings
SL-M10	10kg/m <sup>2</sup> (2lb/ft <sup>2</sup> )
SL-M18	25kg/m <sup>2</sup> (5lb/ft <sup>2</sup> )
SL-M18-FR	25kg/m <sup>2</sup> (5lb/ft <sup>2</sup> )

### QUANTITIES PER SPECIFIED PANEL SIZE

Imperial system

Product code	Description	Per 2 x 2ft area	Per square feet
Orange 1"x 1"x 1/8"	Aluminium U channel	4ft	1ft/ft <sup>2</sup>
SL-SFA1	Female clip	4 units	1 units/ft <sup>2</sup>
SL-M10 or M18	Male clip	4 units	1 units/ft <sup>2</sup>

Metric system

Product code	Description	Per 0.6 x 0.6m area	Per square meter
Orange 1"x 1"x 1/8"	Aluminium U channel	1.2m	2m/m <sup>2</sup>
SL-SFA1	Female clip	4 units	9 units/m <sup>2</sup>
SL-M10 or M18	Male clip	4 units	9 units/m <sup>2</sup>



# Stratlock Range

## CEILING USING STRATLOCK SL-FC SET INTO PLYWOOD

### PANEL SIZE: 2 X 2FT / 600 X 600MM

This document describes the layout of clips for standard panels of the specified size. For custom panels and or custom application please contact Fastmount team or Fastmount distributors for technical support.

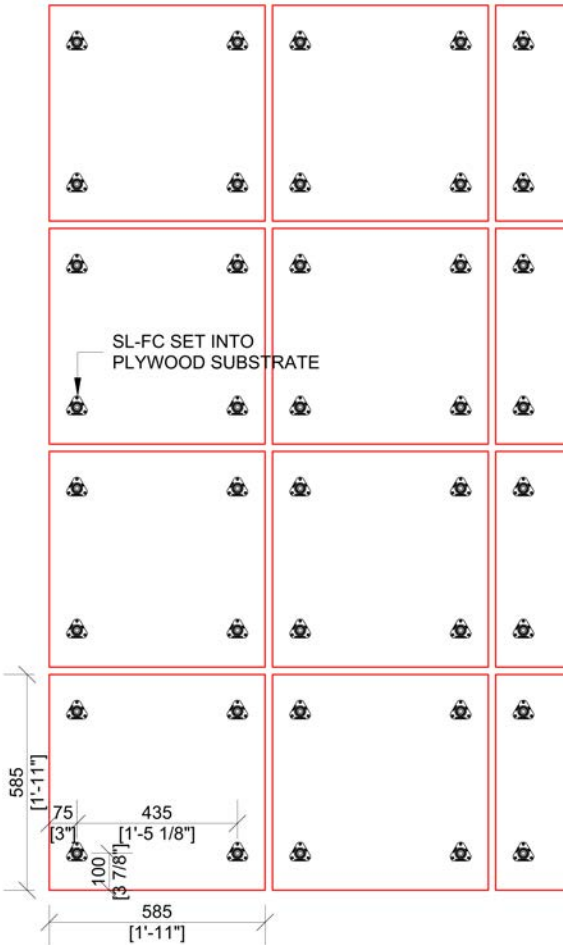

#### VARIATIONS

- The maximum recommended center to center distance between SL-FC is 600mm / 24".
- Place clips between 50 and 100mm / 2 and 4 inches from vertical edge of the panels.

#### TIPS

- For light weight panels or very thin panels, more clips might be advised to avoid wavy edges.

#### PANEL WEIGHT LIMITS

- The maximum panel density for this application is 25kg per m<sup>2</sup> or 5lbs per square foot.
- Male clips SL-M10 can only be applied to panel densities of maximum 10kg per m<sup>2</sup> or 2lbs per square foot. Anything over this should be mounted with the SL-M18 male clips.

Model	Max panel weight density: Ceilings
SL-M10	10kg/m <sup>2</sup> (2lb/ft <sup>2</sup> )
SL-M18	25kg/m <sup>2</sup> (5lb/ft <sup>2</sup> )
SL-M18-FR	25kg/m <sup>2</sup> (5lb/ft <sup>2</sup> )

#### QUANTITIES PER SPECIFIED PANEL SIZE

Imperial system

Product code	Description	Per 2 x 2ft area	Per square feet
SL-FC	Female clip	4 units	1 units/ft <sup>2</sup>
SL-M10 or M18	Male clip	4 units	1 units/ft <sup>2</sup>

Metric system

Product code	Description	Per 0.6 x 0.6m area	Per square meter
SL-FC	Female clip	4 units	9 units/m <sup>2</sup>
SL-M10 or M18	Male clip	4 units	9 units/m <sup>2</sup>



# Stratlock Range

## CEILING USING STRATLOCK RAIL SUSPENDED PANEL SIZE: COMPLEX SHAPES

This document describes the layout of clips for standard panels of the specified size. For custom panels and or custom application please contact Fastmount team or Fastmount distributors for technical support.

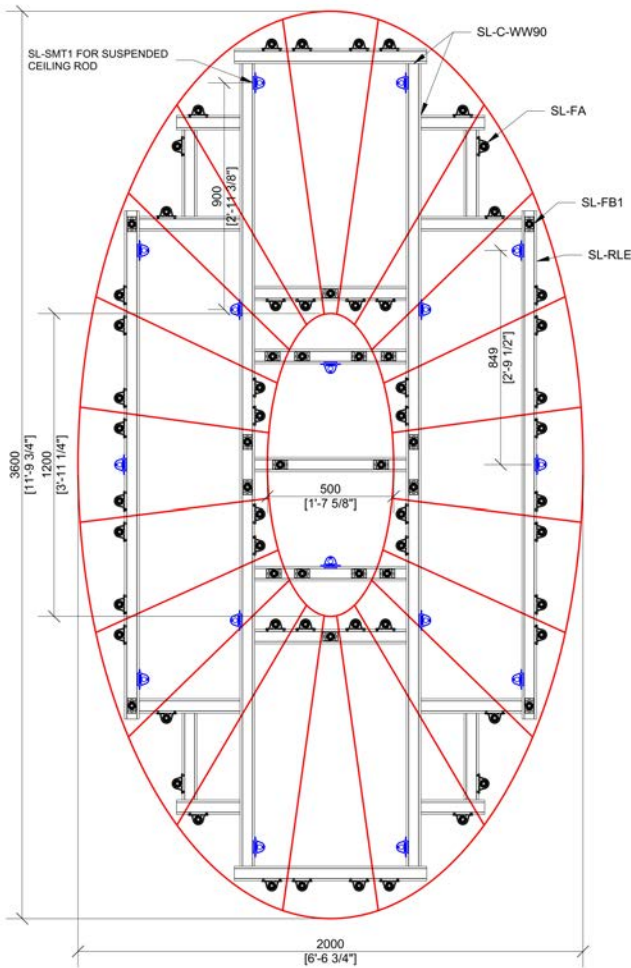

### VARIATIONS

- The maximum recommended distance between rails is 800mm / 2.6ft. Panels larger than described in this layout might require more horizontal and vertical rails depending on layout.
- Place clips between 50 and 100mm / 2 and 4 inches from vertical edge of the panels.

### TIPS

- For light weight panels or very thin panels, more rails might be advised to avoid wavy edges.
- SL-SMT1 @ maximum 900mm/2'11" 3/8" centers and alternate each side as per center vertical rail

### PANEL WEIGHT LIMITS

- The maximum panel density for this application is 25kg per m<sup>2</sup> or 5lbs per square foot.
- Male clips SL-M10 can only be applied to panel densities of maximum 10kg per m<sup>2</sup> or 2lbs per square foot. Anything over this should be mounted with the SL-M18 male clips.

Model	Max panel weight density: Ceilings
SL-M10	10kg/m <sup>2</sup> (2lb/ft <sup>2</sup> )
SL-M18	25kg/m <sup>2</sup> (5lb/ft <sup>2</sup> )
SL-M18-FR	25kg/m <sup>2</sup> (5lb/ft <sup>2</sup> )

### QUANTITIES PER SPECIFIED PANEL SIZE

Imperial system

Product code	Description	Complex area	Per square feet
SL-RLE	Aluminium extrusion	63ft	0.09ft/ft <sup>2</sup>
SL-FB1	Female clip	18 units	0.08 units/ft <sup>2</sup>
SL-FA1	Female clip	52 units	0.25 units/ft <sup>2</sup>
SL-SMT1	Sidemount clip for suspending frame	16 units	0.07 units/ft <sup>2</sup>
SL-C-WW90	Wall to wall connector	34 units	0.16 units/ft <sup>2</sup>
SL-M10 or M18	Male clip	70 units	0.34 units/ft <sup>2</sup>

Metric system

Product code	Description	Complex area	Per square meter
SL-RLE	Aluminium extrusion	19.1m	3.37m/m <sup>2</sup>
SL-FB1	Female clip	18 units	3.18 units/m <sup>2</sup>
SL-FA1	Female clip	52 units	9.2 units/m <sup>2</sup>
SL-SMT1	Sidemount clip for suspending frame	16 units	2.8 units/m <sup>2</sup>
SL-C-WW90	Wall to wall connector	34 units	6 units/m <sup>2</sup>
SL-M10 or M18	Male clip	70 units	12.3 units/m <sup>2</sup>

# Stratlock Range

## CEILINGS USING STRATLOCK RAIL SCREWED TO TBAR PANEL SIZE: COMPLEX SHAPES

This document describes the layout of clips for standard panels of the specified size. For custom panels and or custom application please contact Fastmount team or Fastmount distributors for technical support.

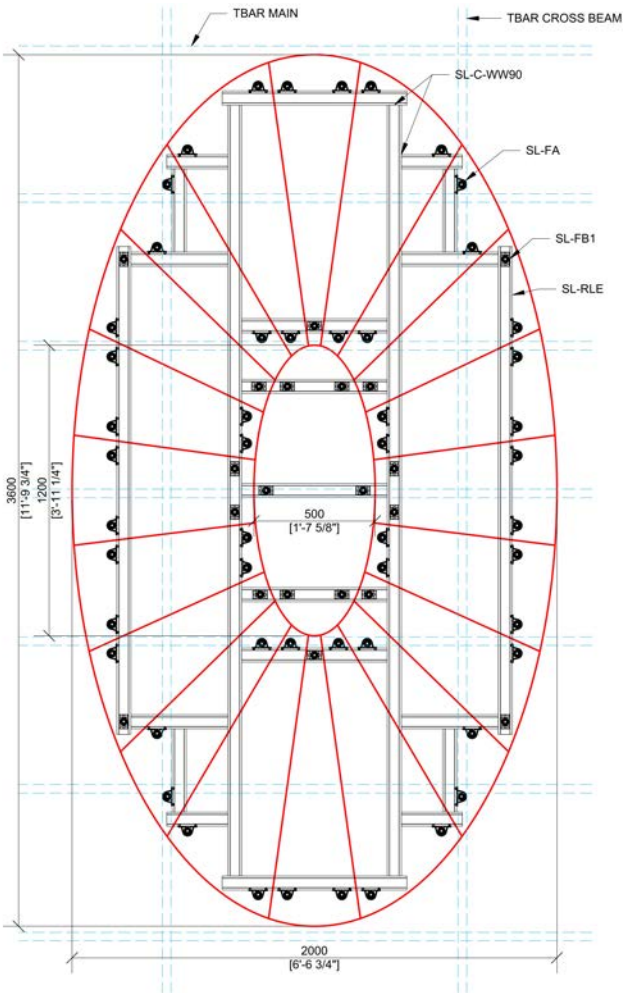

### VARIATIONS

- The maximum recommended distance between rails is 800mm / 2.6ft. Panels larger than described in this layout may require more horizontal or vertical rails depending on layout.
- Place clips between 50 and 100mm / 2 and 4 inches from vertical edge of the panels.

### TIPS

- For light weight panels or very thin panels, more rails might be advised to avoid wavy edge.

### PANEL WEIGHT LIMITS

- The maximum panel density for this application is 25kg per m<sup>2</sup> or 5lbs per square foot.
- Male clips SL-M10 can only be applied to panel densities of maximum 10kg per m<sup>2</sup> or 2lbs per square foot. Anything over this should be mounted with the SL-M18 male clips.

Model	Max panel weight density: Ceilings
SL-M10	10kg/m <sup>2</sup> (2lb/ft <sup>2</sup> )
SL-M18	25kg/m <sup>2</sup> (5lb/ft <sup>2</sup> )
SL-M18-FR	25kg/m <sup>2</sup> (5lb/ft <sup>2</sup> )

### QUANTITIES PER SPECIFIED PANEL SIZE

Imperial system

Product code	Description	Complex area	Per square feet
SL-RLE	Aluminium extrusion	63ft	0.09ft/ft <sup>2</sup>
SL-FB1	Female clip	18 units	0.08 units/ft <sup>2</sup>
SL-FA1	Female clip	52 units	0.25 units/ft <sup>2</sup>
SL-C-WW90	Wall to wall connector	34 units	0.16 units/ft <sup>2</sup>
SL-M10 or M18	Male clip	70 units	0.34 units/ft <sup>2</sup>

Metric system

Product code	Description	Complex area	Per square meter
SL-RLE	Aluminium extrusion	19.1m	3.37m/m <sup>2</sup>
SL-FB1	Female clip	18 units	3.18 units/m <sup>2</sup>
SL-FA1	Female clip	52 units	9.2 units/m <sup>2</sup>
SL-C-WW90	Wall to wall connector	34 units	6 units/m <sup>2</sup>
SL-M10 or M18	Male clip	70 units	12.3 units/m <sup>2</sup>



# Stratlock Range

## CEILINGS SCREWED TO PLYWOOD SUBSTRATE PANEL SIZE: COMPLEX SHAPES

This document describes the layout of clips for standard panels of the specified size. For custom panels and or custom application please contact Fastmount team or Fastmount distributors for technical support.

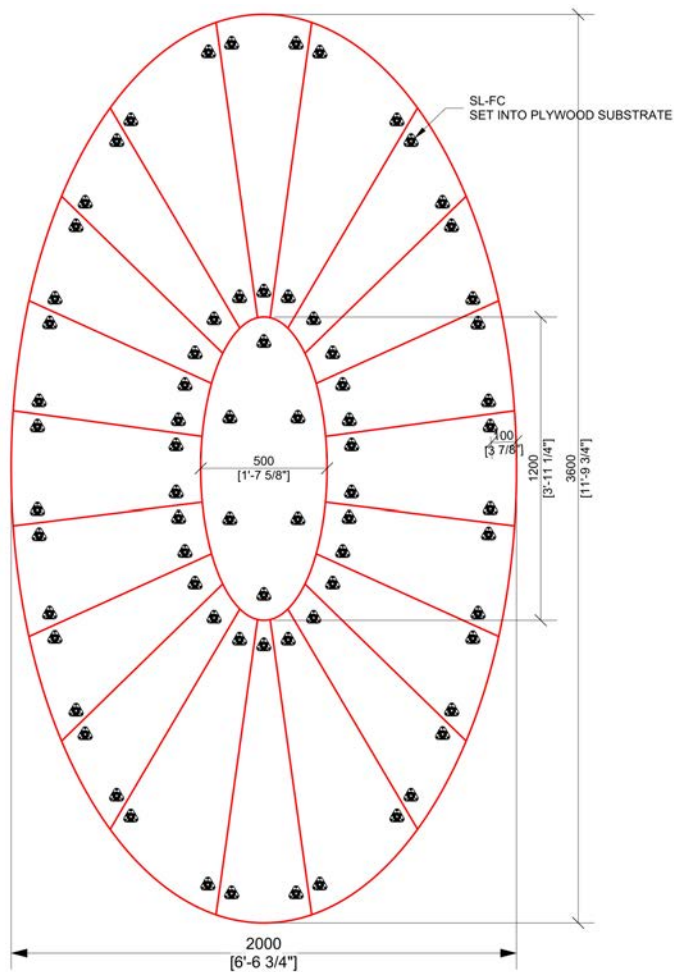

### VARIATIONS

- Place clips between 50 and 100mm / 2 and 4 inches from vertical edge of the panels.

### TIPS

- For light weight panels or very thin panels, more rails might be advised to avoid wavy edges.

### PANEL WEIGHT LIMITS

- The maximum panel density for this application is 25kg per m<sup>2</sup> or 5lbs per square foot.
- Male clips SL-M10 can only be applied to panel densities of maximum 10kg per m<sup>2</sup> or 2lbs per square foot. Anything over this should be mounted with the SL-M18 male clips.

Model	Max panel weight density: Ceilings
SL-M10	10kg/m <sup>2</sup> (2lb/ft <sup>2</sup> )
SL-M18	25kg/m <sup>2</sup> (5lb/ft <sup>2</sup> )
SL-M18-FR	25kg/m <sup>2</sup> (5lb/ft <sup>2</sup> )

### QUANTITIES PER SPECIFIED PANEL SIZE

Imperial system

Product code	Description	Complex area	Per square feet
SL-FC	Female clip	72 units	0.35 units/ft <sup>2</sup>
SL-M10 or M18	Male clip	72 units	0.35 units/ft <sup>2</sup>

Metric system

Product code	Description	Complex area	Per square meter
SL-FC	Female clip	72 units	12.7 units/m <sup>2</sup>
SL-M10 or M18	Male clip	72 units	12.7 units/m <sup>2</sup>

